

Screw Leg Kit Instructions

Bolt Bag Part #: 1004434

1006682 - Dock Screw Leg Kit - Adjustment (with tire): Low: 37.4" High 57.4"
 1006686 - Dock Screw Leg Kit - Adjustment (with tire): Low: 48.4" High 74.4"
 1006681 - Dock Screw Leg Kit - Adjustment (with tire): Low: 66.4" High 105.4"

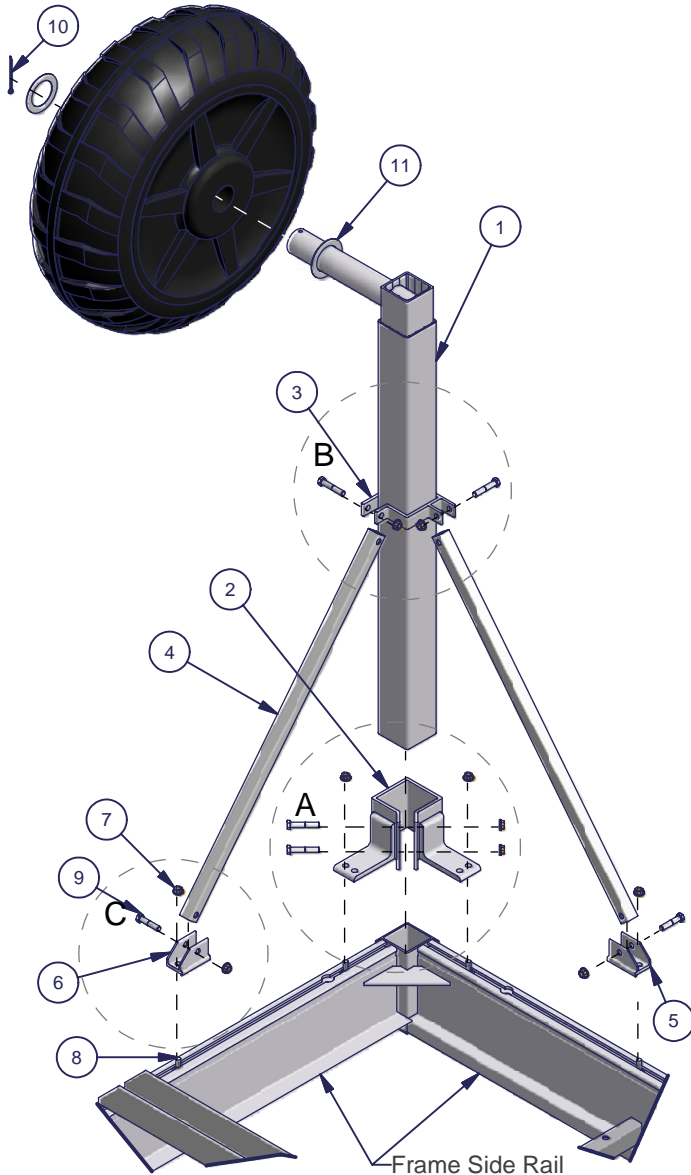

Note: When using Deep Water Screw Legs on a straight section of dock the Support Tube - Deep from one leg will interfere with the Support Tube - Deep from the other leg. Attach one of the Support Tubes - Deep diagonally, as normal, and attach a Deep Water Screw Leg Cross Tube (sold separately) to both Screw Legs - Deep - as shown in Detail "D." The Deep Water Screw Leg Cross Tube includes one Bolt 3/8 x 3.0 for attaching through both tubes and the Support Pinch Bracket. Use the hardware included with Screw Leg to complete the attachment. If desired one of the Support Tubes - Deep can be cut at 41-1/16". Drill a 7/16" hole 1/2" from the cut end.

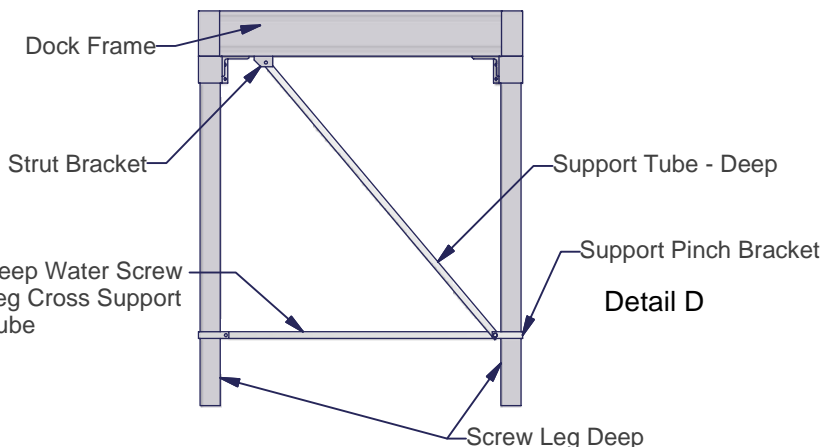
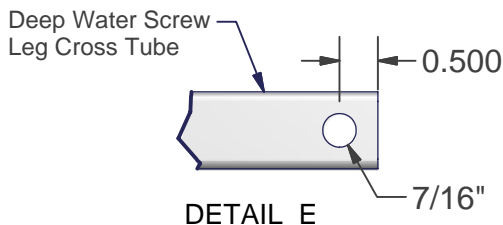

Parts List			
ITEM	QTY	PART NUMBER	DESCRIPTION
1		1003454	Dock Screw Leg - Shallow
1	1	1003455	Dock Screw Leg - Standard (shown)
1		1003456	Dock Screw Leg - Deep
2	1	1001271	Pinch Pocket
3	1	1003120	Support Pinch Bracket
4		1003133	Support Tube - Shallow (20)
4	2	1003132	Support Tube - Standard (30) (shown)
4		1003131	Support Tube - Deep (54)
5	1	1000006	Strut Bracket Right
6	1	1000008	Strut Bracket Left
7	10	1001802	Nut Flange 3/8
8	4	1001956	Bolt Carriage 3/8 X 1.0
9	6	1002424	Bolt 3/8 X 2.0
10	1	1002569	Cotter Pin 1/4 X 2.5
11	2	1001763	Washer - Poly Tire

- Note:** The wheels can be positioned to the inside or the outside of the frame. For best stability position the wheels toward the outside of the frame.
- Assembly:** To ensure the correct quantity of hardware in the right places, the Screw Leg Kit should be assembled at the same time as the dock frame and L Brace assembly. If it is not, you may have to disconnect some components to add hardware.
- Note:** Before attaching any parts together lay the dock frame upside down (to access the bottom) and slide all the Bolts Carriage 3/8 in the "T" Slot that are necessary for all the components that will be used (connector clips, support brackets, etc.).
- Slide the Support Pinch Bracket onto the Screw Leg without securing.
 - Slide the Pinch Pocket onto the end of the Screw Leg without securing.
 - With the Screw Leg in place, secure the Pinch Pocket to the dock frame corner with two Bolts Carriage 3/8 x 1.0 and two Nuts Flange 3/8 as shown in Detail "A."
 - Secure the Screw Leg to the Pinch Pocket with two Bolts 3/8 x 2.0 and two Nuts Flange 3/8.
 - Loosely attach one Support Tube to each set of tabs on the Support Pinch Bracket with one Bolt 3/8 x 2.0 and one Nut Flange 3/8 as shown in Detail "B."
 - Loosely attach the Strut Bracket Right and the Strut Bracket Left to the "T" Slot of each Frame Side Rail with one Bolt Carriage 3/8 x 1.0 and one Nut Flange 3/8 - as Shown in Detail "C."
- Note:** The tabs of the Strut Brackets face the inside of the frame.
- Position the Support Tubes at a 45 degree angle to the frame.
 - Slide the Strut Brackets Left and Right in-line with the through hole of the Support Tubes and tighten the Nut Flange 3/8 on each Strut Bracket.
 - Attach each Support Tube to one of the Strut Brackets with one Bolt 3/8 x 2.0 and one Nut Flange 3/8 - as shown in Detail "C."
 - Secure the Support Pinch Bracket to the Support Tubes and the Screw Leg by tightening the Bolts and Nuts from Step 5 - as shown in Detail "B."
- Note:** Make sure all Bolts and Nuts are fully tightened.
- Secure a Poly Tire on the axle of the Screw Leg with two Washers - Poly Tire and one Cotter Pin 1/4 x 2.5.