

Part # 1018579
 Accessory Galva-Foam Dock
 Accessory Bracket

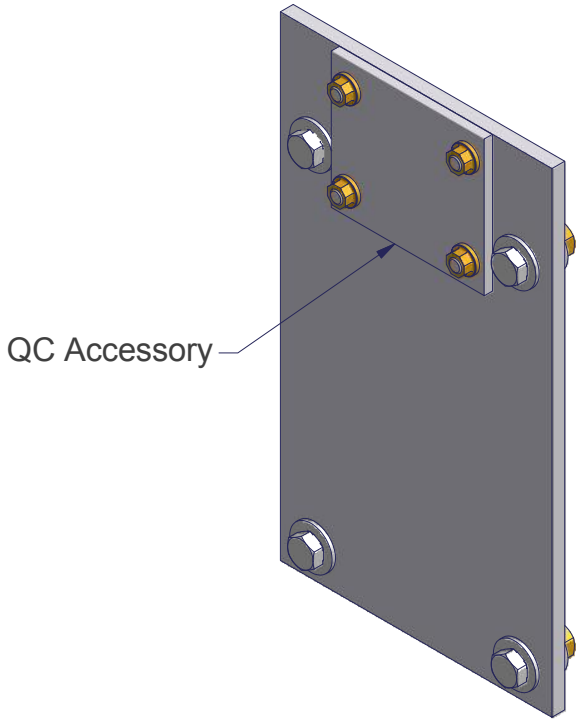

Step 1: Attach QC accessory to Prt Plate Aluminum 3/8 x 8 x 14 - Galva-Foam Acc Mount using 3/8" counter sunk bolts and 3/8" flange nuts.

Step 2: Attach Prt Plate Aluminum 3/8 x 8 x 14 - Galva-Foam Acc Mount to Galva-Foam 12" truss dock using 1/2" hex bolts, washers and nylock nuts.

Note: Bracket may be used to attach accessories to other docks but you may need to drill holes or need other hardware.

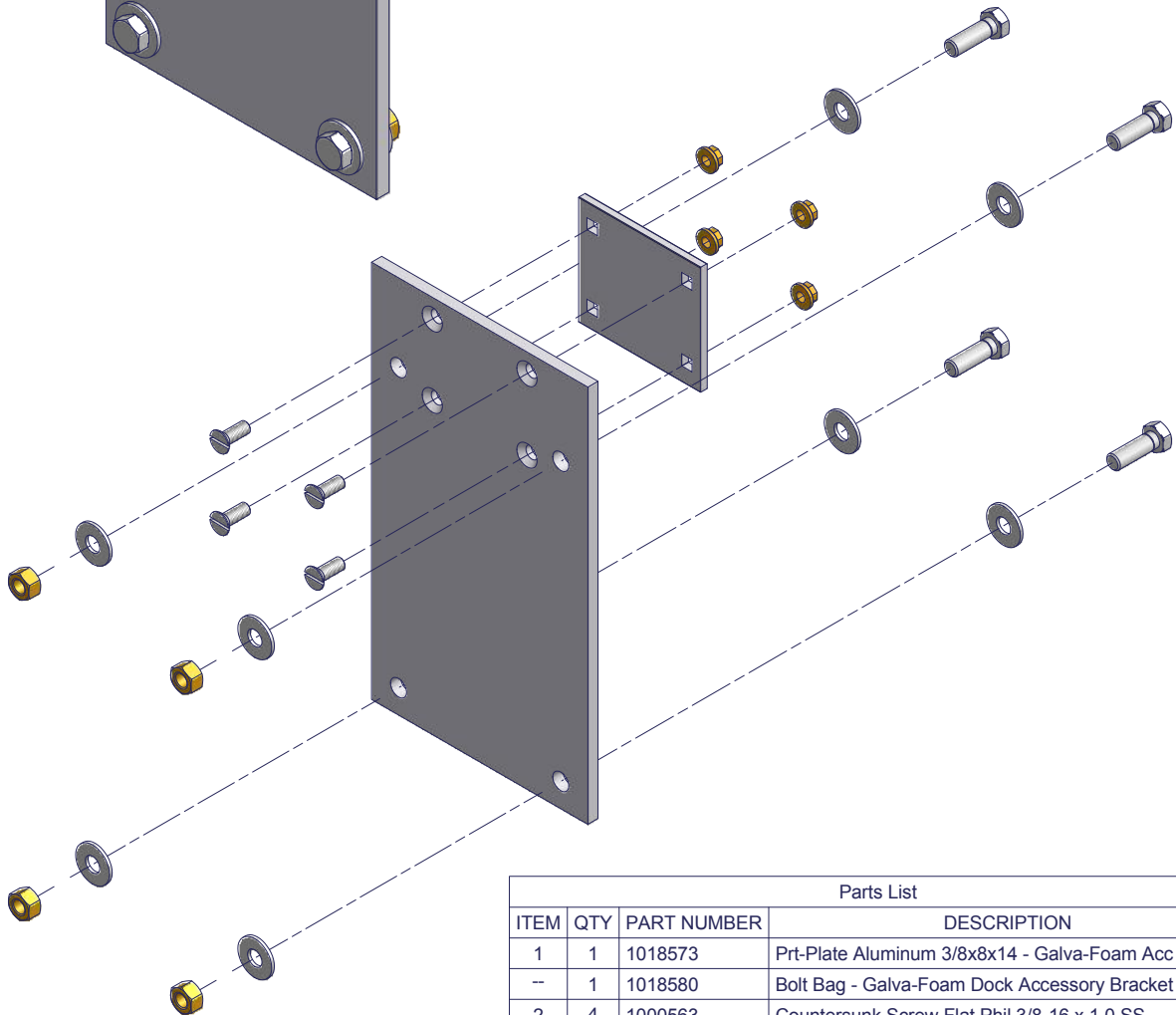

Parts List			
ITEM	QTY	PART NUMBER	DESCRIPTION
1	1	1018573	Prt-Plate Aluminum 3/8x8x14 - Galva-Foam Acc Mount
--	1	1018580	Bolt Bag - Galva-Foam Dock Accessory Bracket
2	4	1000563	Countersunk Screw Flat Phil 3/8-16 x 1.0 SS
3	4	1001802	Nut Flange 3/8-16 Brass
4	4	1001795	Nut Nyloc 1/2-13 Brass
5	8	1002565	Washer Flat 1/2 SS
6	4	1002377	Bolt Hex 1/2-13 x 1.5 SS 304