



Adjustable Pontoon Motor Stop

Step 1: Slide Motor Stop End Frame into the long arm of the Motor Stop Arms and bolt in desired position with two Bolts 3/8 x 2 and two Nuts 3/8 Brass - as shown.

Step 2 : Slide the short arm of Motor Stop Arms into the Adjustable Cradle Pockets and bolt in desired position using two Bolts 3/8 x 2.25 and two Nuts 3/8 Brass.

Step 3 : Slide the Adjustable Cradle Pockets over the rear rack beam, (straight rack shown, V-rack available) center on rear rack beam and bolt into position using four Bolts 3/8 x 3, and four Nuts Flange 3/8 Brass - as shown.

*Note: Adjustable pontoon motor stop may require adjustment once pontoon has been positioned on lift.

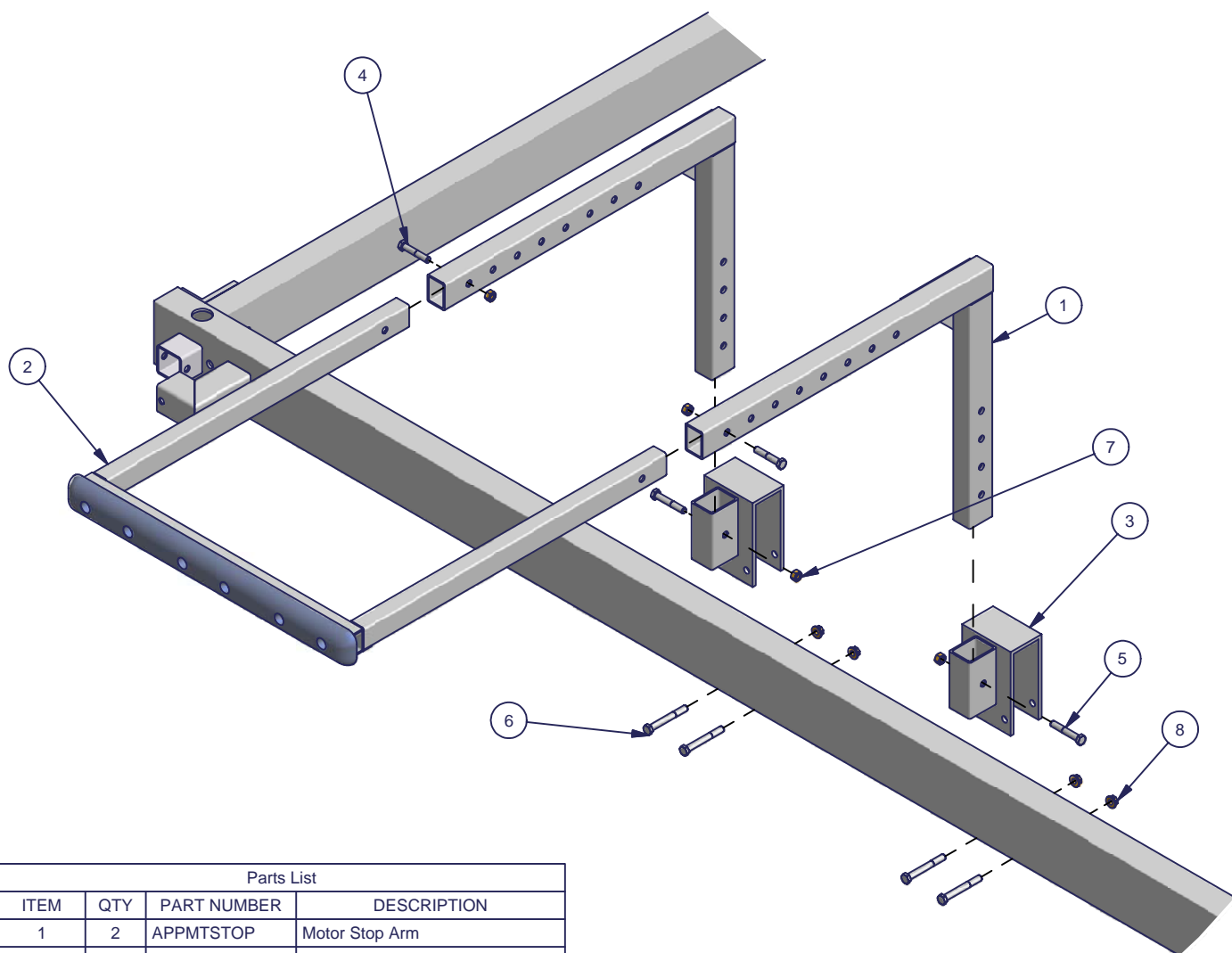

Parts List			
ITEM	QTY	PART NUMBER	DESCRIPTION
1	2	APPMTSTOP	Motor Stop Arm
2	1	APPMSFRM	Motor Stop End Frame
3	2	APADJPKCT	Adjustable Cradle Pocket
4	2	MS380200B	BOLT 3/8 X 2
5	2	MS380214B	BOLT 3/8 X 2.25
6	4	MS380300B	BOLT 3/8 X 3
7	4	B380RGNUT	NUT 3/8 BRASS
8	4	B380FLNUT	NUT FLANGE 3/8 BRASS