

'09 Whisper Winch Sidewinder Assembly

Step 1

Attach the Motor Bracket to the '09 Whisper Winch as shown, using the rear hole pattern.

Step 2

Add one Large Washer and one Bronze Brake Pad to the Shaft of the Winch. Thread the Large Gear onto the drive shaft. Place the Spacer on the end of the Shaft. Bolt the Aluminum Washer to the end of the drive shaft with one Bolt 5/16 x 1.

Note: The '09 Whisper Winch has one Bronze Brake Pad and the Sidewinder also comes with one. Sandwich the Large Washer with the two Bronze Washers.

Attach the Motor to the Motor Mount Bracket. Secure with four Flange Bolts - as shown.

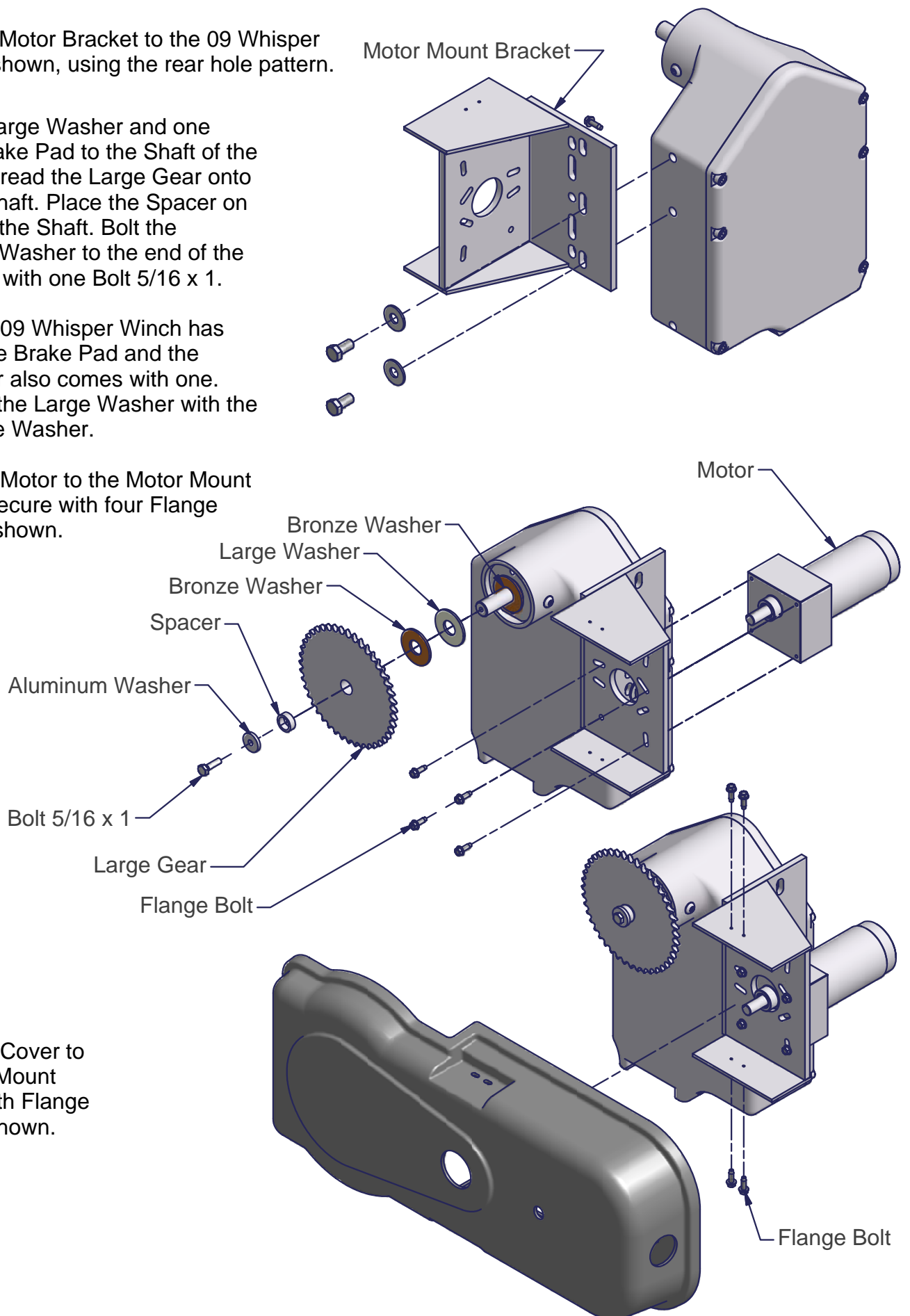

Step 3

Attach the Cover to the Motor Mount Bracket with Flange Bolts, as shown.