

QC Pivoting Ladder

DAQCLADD3
 DAQCLADD4
 DAQCLADD5

QC Pivoting Ladder 3 Step
 QC Pivoting Ladder 4 Step
 QC Pivoting Ladder 5 Step

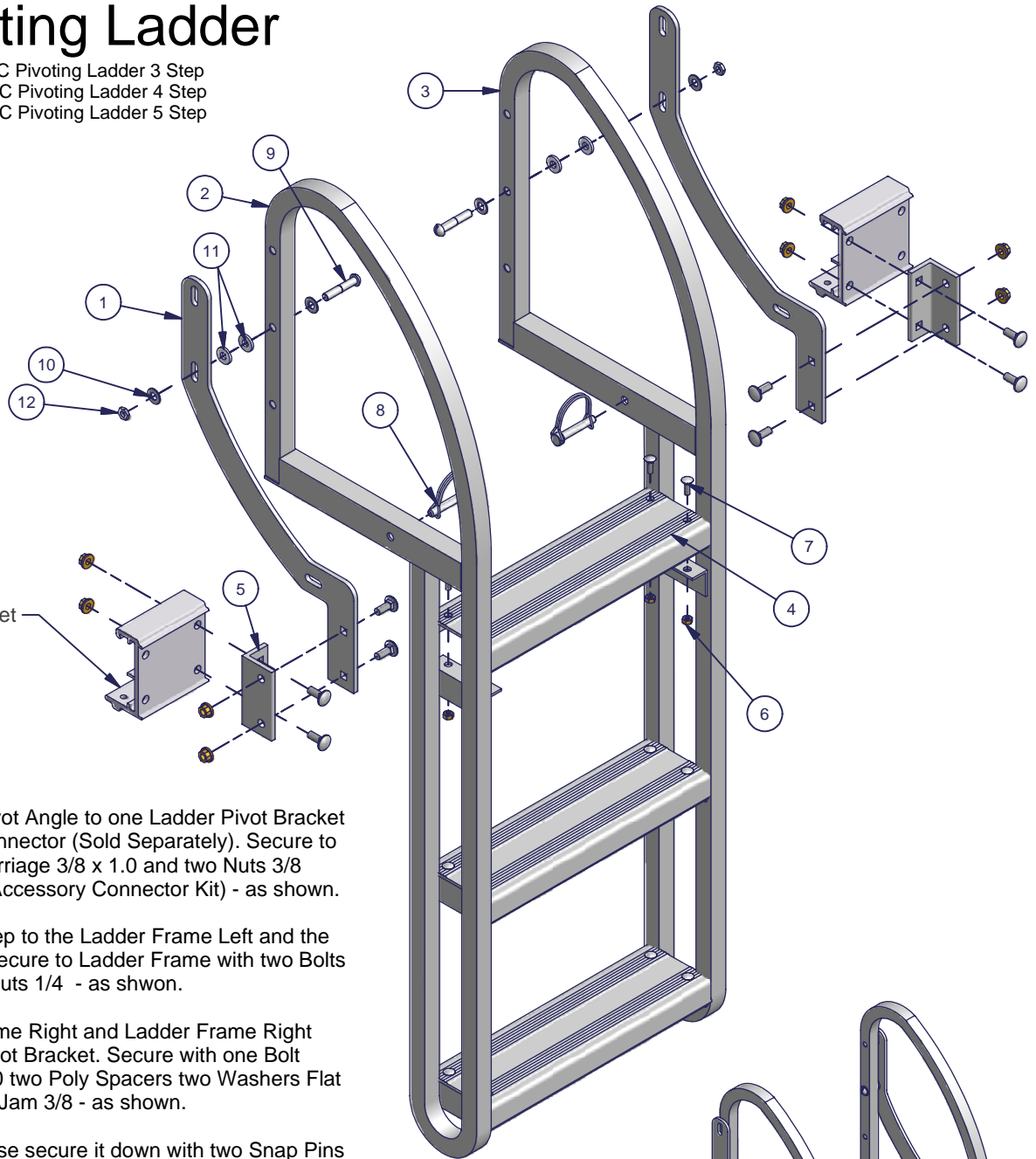

Quick-Connect Bracket
 (Sold Separately)
 DARS4QCAB - RS4
 DARS7QCAB - RS7
 DATS9QCAB - TS9

Assembly:

Attach each Ladder Pivot Angle to one Ladder Pivot Bracket and one Accessory Connector (Sold Separately). Secure to each with two Bolts Carriage 3/8 x 1.0 and two Nuts 3/8 Flange (included with Accessory Connector Kit) - as shown.

Attach each Ladder Step to the Ladder Frame Left and the Ladder Frame Right. Secure to Ladder Frame with two Bolts Carriage 1/4 and two Nuts 1/4 - as shown.

Attach the Ladder Frame Right and Ladder Frame Right each to one Ladder Pivot Bracket. Secure with one Bolt Slotted Round 3/8 x 2.0 two Poly Spacers two Washers Flat 3/8 and one Nut Nyloc Jam 3/8 - as shown.

While the ladder is in use secure it down with two Snap Pins - as shown.

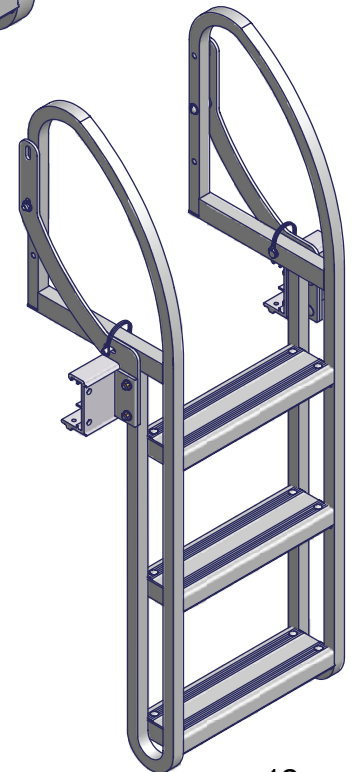

3 Step Ladder Shown			
ITEM	QTY	PART NUMBER	DESCRIPTION
1	2	600016399	Ladder Pivot Bracket
2	1	AP3LDRFML	Ladder Frame Left
3	1	AP3LDRFMR	Ladder Frame Right
4	3	APSLSTEPS	Ladder Step
-	1	500016414	Bolt Bag (4 Step = 500016415, 5 Step = 500016416)
5	2	001016412	Ladder Pivot Angle
6	12	B140RGNUT	Nut 1/4 (4 step = qty 16, 5 step = qty 20)
7	12	CS140034B	Bolt Carriage 1/4 x 3/4 (4 step = qty 16, 5 step = qty 20)
8	2	38SNAPPIN	Snap Pin
9	2	MS380200T	Bolt Truss Head 3/8 x 2.0
10	4	S380WASHR	Washer Flat 3/8
11	4	P380WASHR	Plastic Spacer
12	2	S38NYLJAM	Nut Nyloc Jam 3/8